

▶ HIGH EFFICIENT FACTORY OPTIONS.....1

▶ MODULAR MARKETWATCH.....1

▶ ENERGY STAR MODULAR HOMES2

▶ MODULAR CONSTRUCTION FINANCING.....2

○ ISSUE 2 | ○ VOLUME 3 | ○ February 2009

Modular Press

CUSTOM MODULAR DESIGNS, LLC. PROVIDES THE CURRENT TRENDS IN MODULAR HOME BUILDING

Our Standards Keep You Safe!

Our modular homes come with many standards that you won't find from other Modular Home companies. Not only are our standards higher but they also provide you with the peace of mind that your family is safe. To illustrate we have listed a number of standards we offer and the benefits they provide.

Low E Windows - Prevents window condensation from occurring at much higher relative humidity levels than regular single or double-paned windows.

Argon Filled Glass - Argon filled glass is available for all of our modular homes and increases the energy efficiency of our modular homes.

Tight Construction - Our modular homes' craftsmanship and tight construction reduces energy robbing air infiltration. Tight construction is the first step in improving indoor air quality by putting the home owner in control of the air which is introduced into the home.

Bath Ventilation Units - Our homes come standard with fan/lights in all baths, vented to the exterior.

Ridge Vent & Vented Soffit - Ridge vent and vented soffit help prevent heat and moisture in the attic area.

Fiberglass Exterior Doors - Our homes come standard with fully insulated, weather stripped front and rear fiberglass exterior doors preventing air leakage at these critical areas.

Countertop Backsplash - Standard kitchen countertops come complete with a laminate backsplash, which prevents water from spilling between your cabinets and the wall.

Range Hoods - Our kitchens come with a range hood over the cook top, vented to the exterior.

Green board - We use green-board (water resistant wall board) at bath and shower areas.

For further information on our modular homes please visit our website www.custommodulardesigns.com



Highly Efficient Factory Options

We provide many options in products that increase the efficiency of your modular home. These options can contribute to your modular homes' Energy Star Rating.

- R-19 or R-21 wall insulation
- R 30 or R-38 attic ceiling insulation
- Argon filled window glass
- Passive solar design plans.
- Open and closed cell blown foam insulation available.
- Radiant in-floor heat.
- High velocity air conditioning.
- Rigid foam insulation available on the exterior walls (1", 2", and 3")
- Other high efficiency options available upon request.

To learn more about our upgrades view our building specifications on the website or contact us at 401.490.0944.

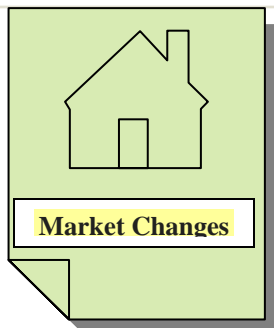

MODULAR MARKET WATCH

Granite countertops might be a staple for some homeowners but Silestone countertops is finding a rise in the market. The fact that it is stain resistant, scratch resistant, scorch resistant, maintenance free and beautiful makes it the perfect product for many of our homeowners. To learn more about the Silestone products we offer please contact our office at 401.490.0944. For further information regarding the products we have available visit our website www.custommodulardesigns.com.



Energy Star Modular Homes

Guidelines for building a modular home that meets or exceeds Energy Star rating.

We have compiled a list of general guidelines to consider when building a new modular home to meet or exceed ENERGY STAR ratings. To meet these levels there are items which must be completed by our factory and items which must be completed by you on-site.

Your new modular home must undergo inspection and testing by a third-party rating agency before it can receive the ENERGY STAR label.

GENERAL DESIGN CONSIDERATIONS:

Limit the excessive use of windows in your design.

Consider the use of argon filled window glass.

Discourage the use of recess lighting. If recess lighting cannot be avoided, specify AT/IC (Air Tight/Insulation Contact) rated fixtures.

If a gas range is used, position so the range can be vented to the exterior of the modular home.

It is preferable to place the range on an exterior wall of the modular home to reduce duct length.

The use of ENERGY STAR labeled appliances in your new modular home is recommended.

The use of "Non-vented" or "Ventless" appliances, such as fireplaces in your new modular home is prohibited.

Have your modular home design pre-checked by your local ENERGY STAR office so requirements for certification can be discussed during the planning stage.

ENERGY STAR labeled modular homes offer savings every month

through utility bills that are significantly lower than those of equivalent, standard homes. These savings can amount to hundreds of extra dollars every year. Our modular homes have tighter construction, which eliminates drafts, reduces outside noise and blocks the entry of airborne pollutants. Tighter ducts improve airflow, allowing you to maintain a desired temperature throughout your modular home. They also reduce exposure to indoor pollutants which enter duct work through leaks in attics, basements and garages.

To learn more about the Energy Star program visit our website. For information on the ENERGY STAR office nearest you, go to www.energystar.gov or call 1-888-STAR-YES.

MODULAR CONSTRUCTION FINANCING:

Finance Company of the Month



Westerly Community Credit Union

Paula Jackson

122 Granite St.
Westerly, RI. 02891

Phone: 401.596.7000 ext 341
Email: PJackson@WesterlyCCU.com
Website: www.westerlyccu.com

Home of the Month

Newport
\$59,300.00*

24 x 40'

Raised Ranch

2 Bedrooms, 1 Bathroom
Dining Room, Living Room, Kitchen

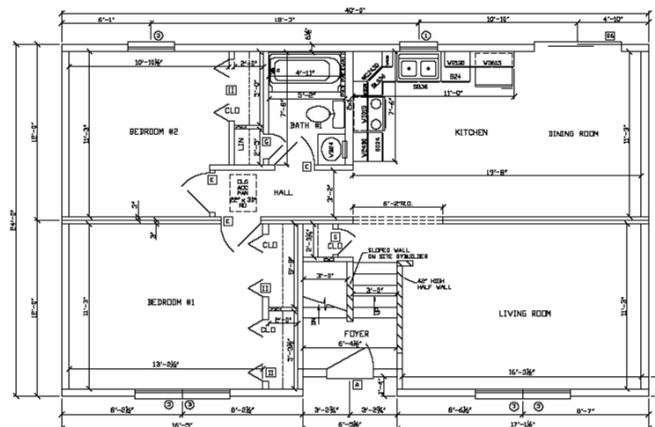

CUSTOM MODULAR
DESIGNS, LLC

94B Jefferson Blvd.
Warwick, RI. 02888
401-490-0944

www.custommodulardesigns.com

CALL CUSTOM MODULAR DESIGNS FOR ALL OF YOUR MODULAR CONSTRUCTION NEEDS AND FIND OUT WHY CUSTOM MODULAR DESIGNS, LLC IS THE FASTEST GROWING MODULAR COMPANY IN NEW ENGLAND.

Copyright protected worldwide. No portion of this newsletter may be copied or reproduced in whole or in part without the express written consent of Custom Modular Designs, LLC.